

LOCATION MAP

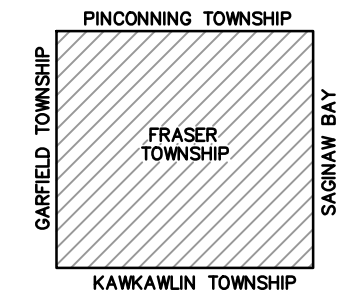

LEGEND

- ADJACENT COUNTY
- CITY, VILLAGE OR PRIVATE STREET
- URBAN LIMITS
- COUNTY PRIMARY ROADS
- COUNTY LOCAL ROADS
- STATE TRUNK LINE
- RAILROADS
- CITY OR VILLAGE LIMITS
- SECTION LINES

PRIMARY ROAD SYSTEM 28.39 MILES
 LOCAL ROAD SYSTEM 54.85 MILES

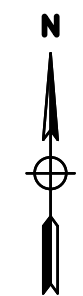

SCALE: 1" = 3000'

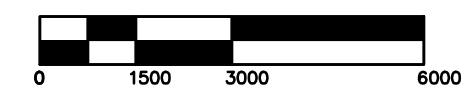

REVISED BY: EJD

DATE: 02/08/19

FRASER TOWNSHIP

T.16 N. - R.04 E.
 BAY COUNTY

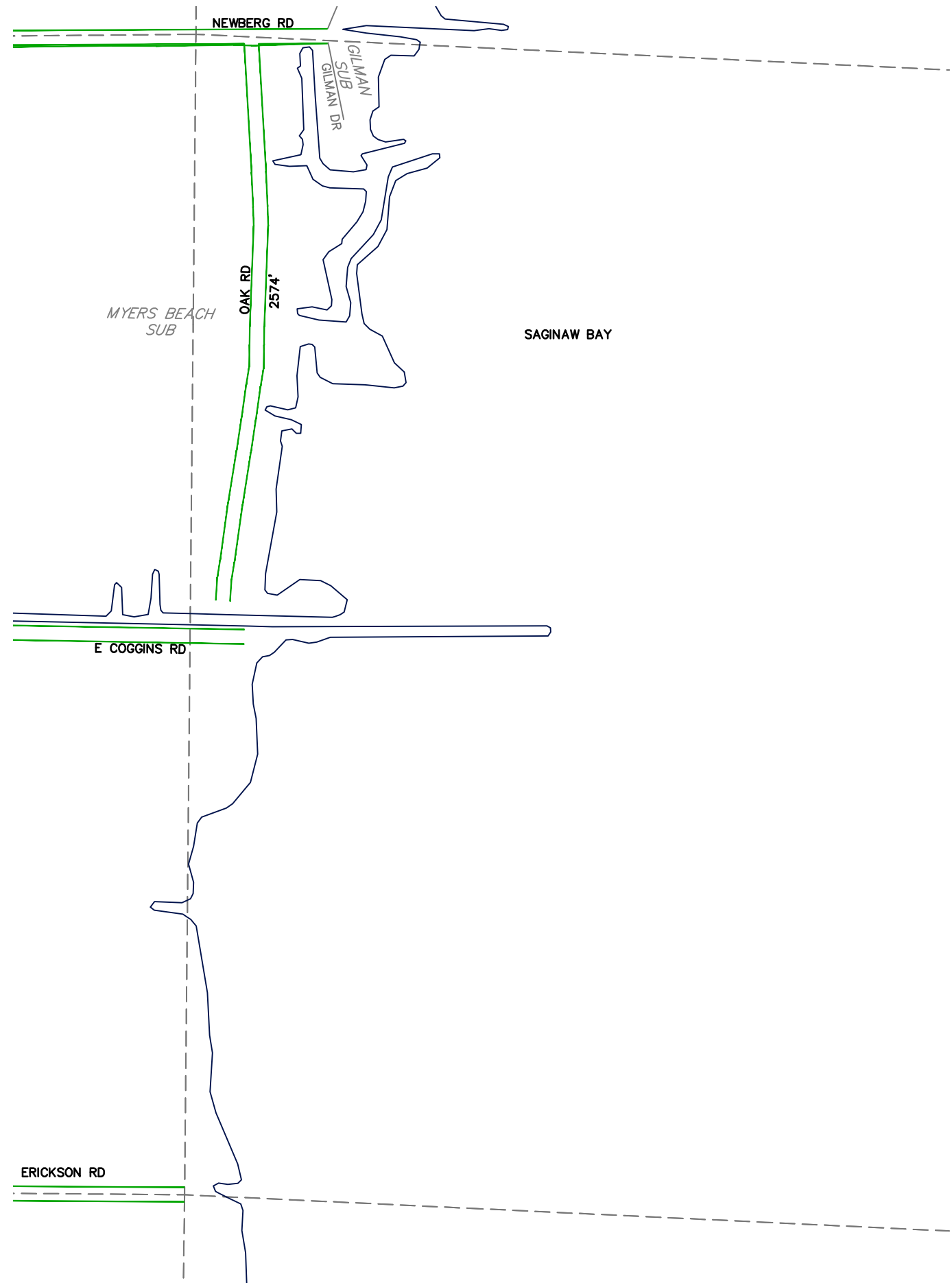

LEGEND

- SECTION LINES
- ADJACENT COUNTY
- CITY, VILLAGE OR PRIVATE STREET
- URBAN LIMITS
- COUNTY PRIMARY ROADS
- COUNTY LOCAL ROADS
- STATE TRUNK LINE
- RAILROAD TRACKS
- CITY OR VILLAGE LIMITS

TOTAL FEET 2,574 = 0.49 MILES

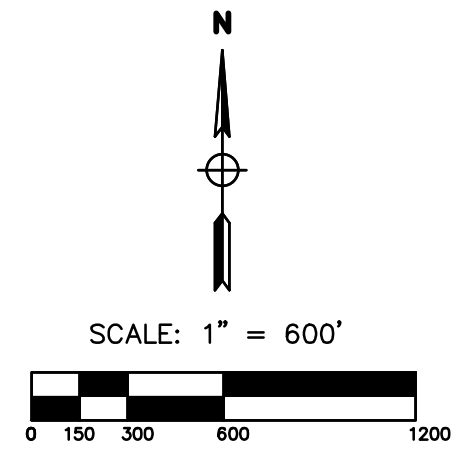

REVISED BY: CLW
 DATE: 05/05/14

FRASER TOWNSHIP
 SECTION 7 (FRACTIONAL)
 T.16 N. - R.05 E.
 BAY COUNTY

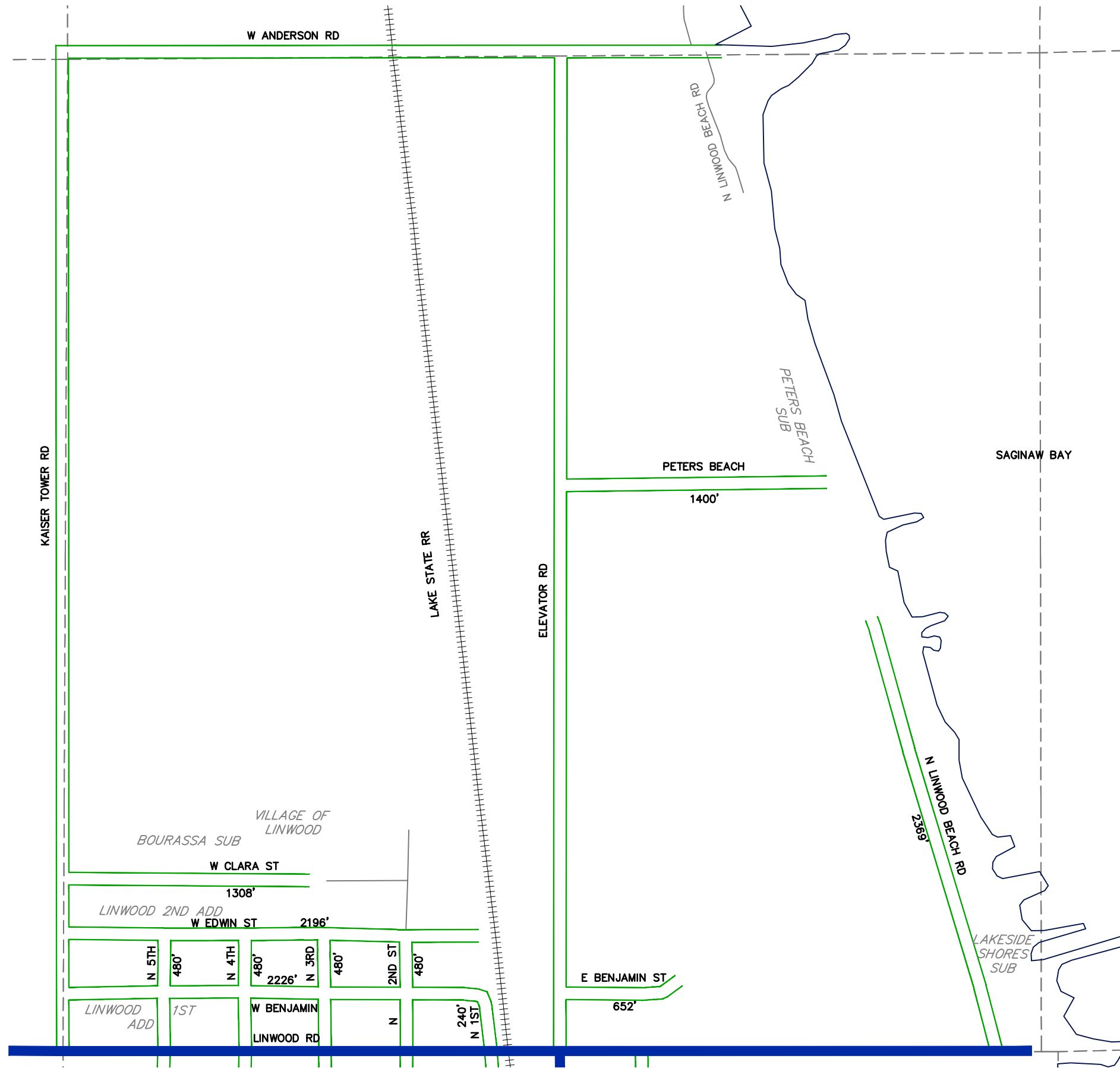

LEGEND

- SECTION LINES
- ADJACENT COUNTY
- CITY, VILLAGE OR PRIVATE STREET
- URBAN LIMITS
- COUNTY PRIMARY ROADS
- COUNTY LOCAL ROADS
- STATE TRUNK LINE
- RAILROAD TRACKS
- CITY OR VILLAGE LIMITS

TOTAL FEET 12,311 = 2.33 MILES

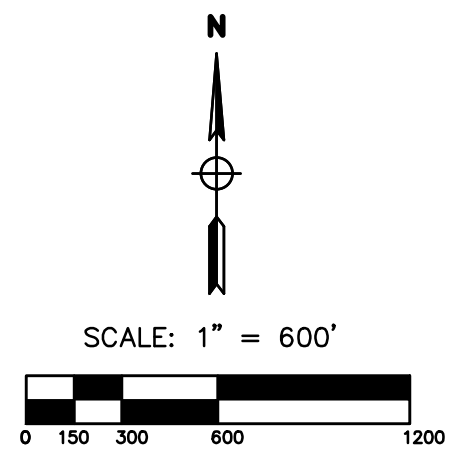

REVISED BY: CLW
 DATE: 05/05/14

FRASER TOWNSHIP
 SECTION 35
 T.16 N. - R.04 E.
 BAY COUNTY